

# MACHINE SCREW ACTUATORS

## 1000 LB CAPACITY

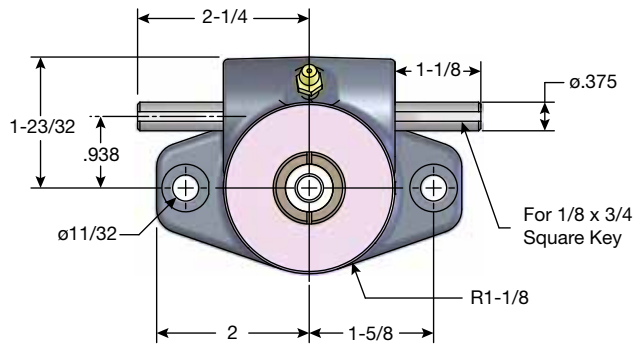

**5/8 Diameter x .125 Lead Lifting Screws**

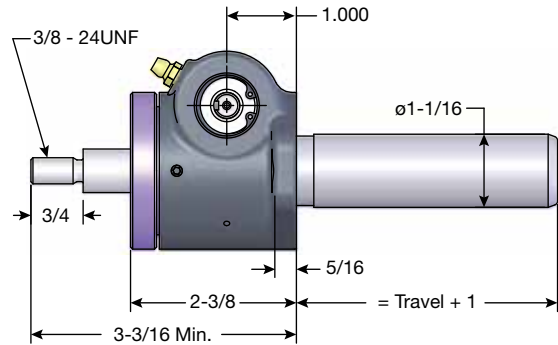

**Upright: B9250T**

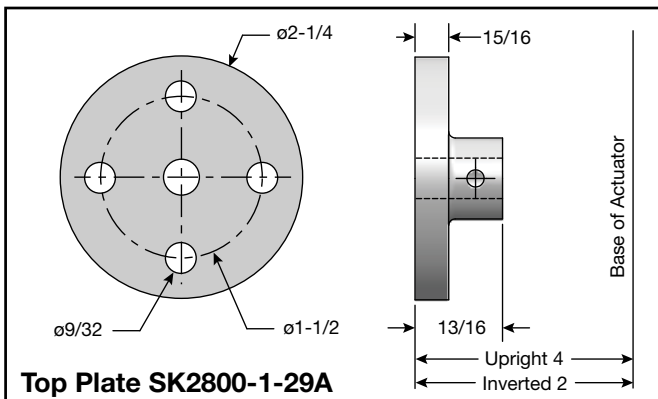

**Top Plate SK2800-1-29A**

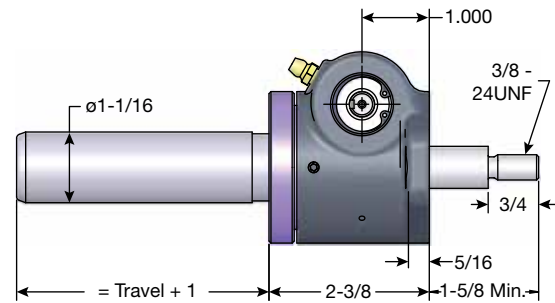

**Inverted: B9250TV**

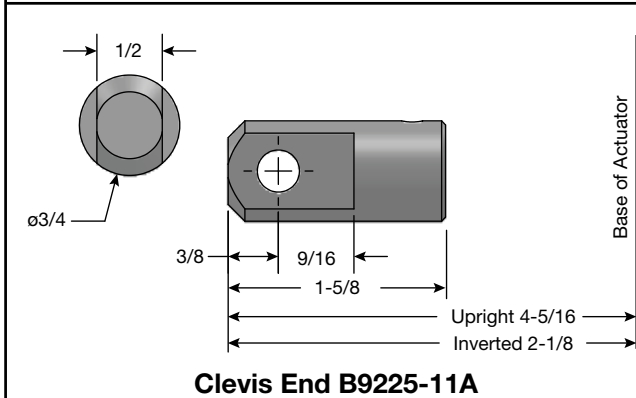

**Clevis End B9225-11A**

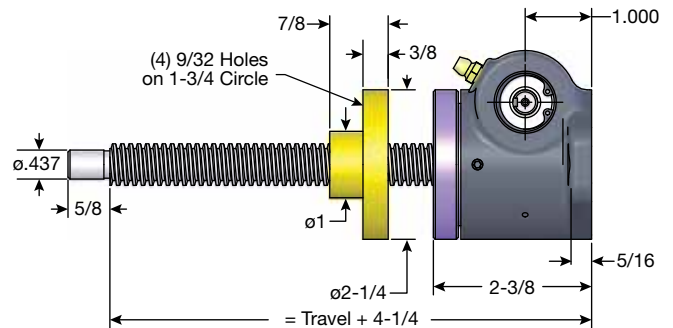

**Upright Rotating: B9250U**

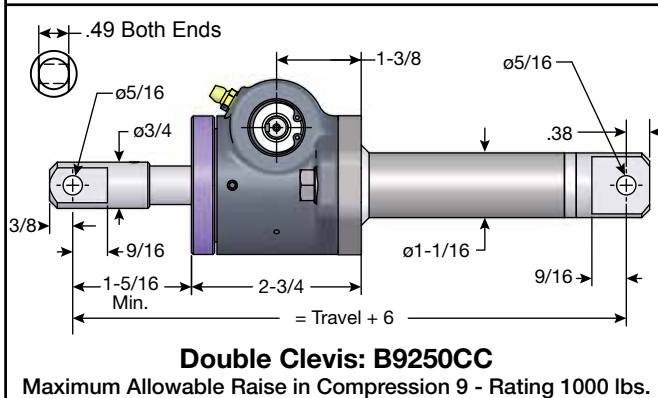

**Double Clevis: B9250CC**

Maximum Allowable Raise in Compression 9 - Rating 1000 lbs.

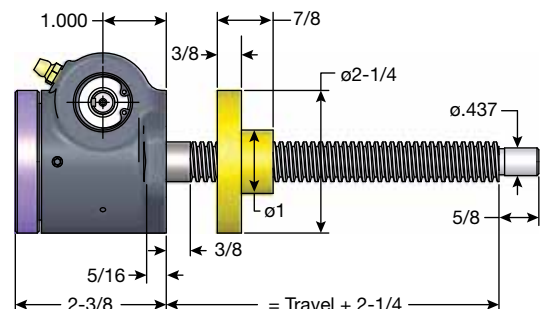

**Inverted Rotating: B9250D**

Note: Lifting screw is not keyed. Top should be secured to a lifting member to prevent rotation. When a Bellows Boot is required, see pages 148-149. Dimensions are subject to change without notice. When the lifting screw is keyed, the holes in the top plate will not necessarily be in the position shown.