

HYBRID STEPPING MOTOR SPECIFICATION

(DIMENSIONS) unit=mm

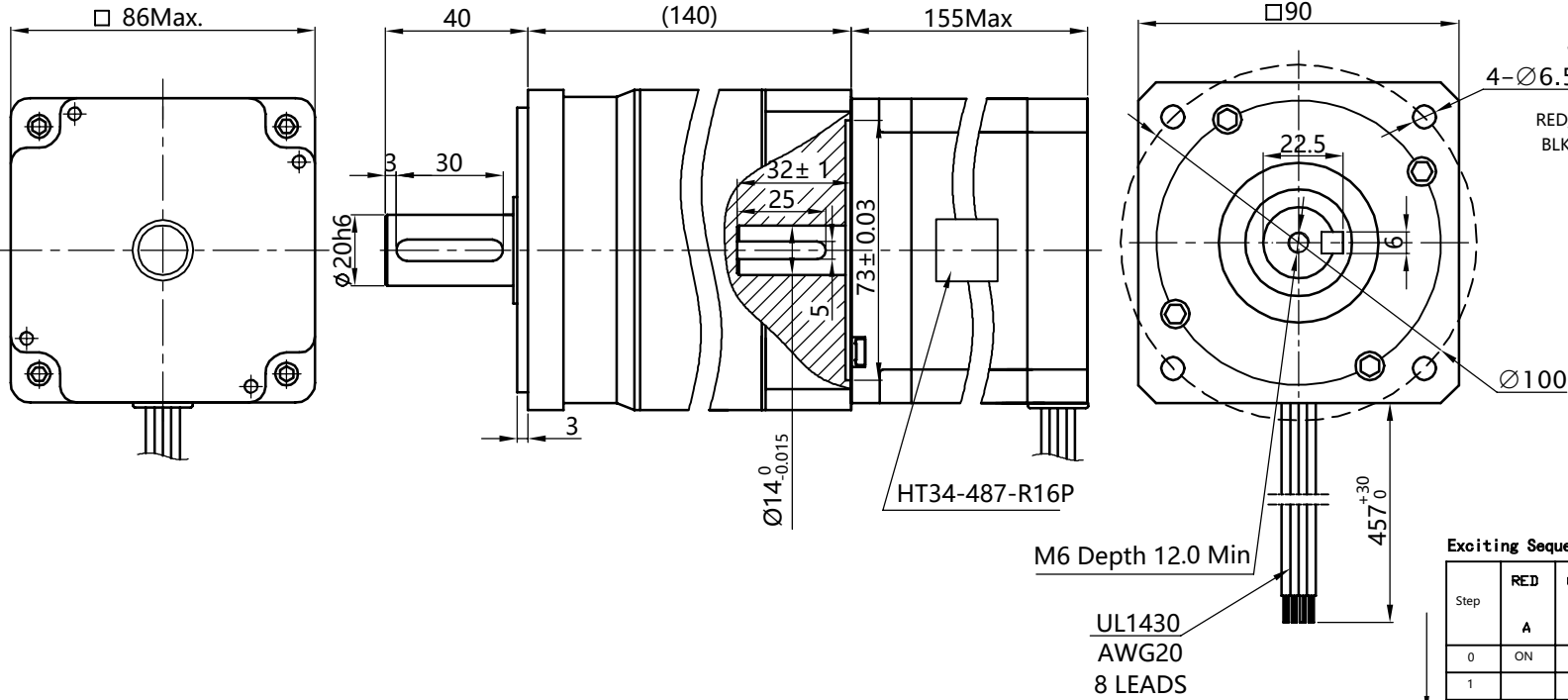

Exciting Sequence vs. Direction of Rotation

Step	RED A	GRN B	BLK \bar{A}	YEL \bar{B}	RED/WHT BLK/WHT COM.	GRN/WHT YEL/WHT COM.
0	ON	ON			+V	
1		ON	ON		+V	
2			ON	ON	+V	
3	ON			ON	+V	
4	ON	ON			+V	

Clockwise view from mounting side

1, Number of Phase	2
2, Step Angle	1.8° deg.
3, Rated Voltage	3.47 V
4, Rated Current/Phase	6.3 A (Peak Value)
5, Phase Resistance	0.55 $\Omega \pm 0.1(20^\circ\text{C})$
6, Phase Inductance	3 mH $\pm 20\%(1\text{kHz } 1\text{V RMS})$
7, Holding Torque	90 kg.cm
8, Insulation Class	B (130°) ;温升 80K Max.
9, Weight	5.6 kg
10, Return clearance	$\leq 15\text{arcmin}$



1. 1:16

REV	日期 DATE
设计 DESIGN	2020.10.26
标准化 STANDARD	www.kalatec.com.br
工艺 TECHNOLOGY	Specification
审核 CHECK	
批准 APPROVE	

TITLE	STEPPING MOTOR			
DWG. NO.	KTC-HT34-487-R16P			
MATERIAL			SIZE	A4
版本 REV.	A	比例 SCALE	1:2	页 SHEET 1 of 1

Specifications

备注 Comment